

# INSTALLATION INSTRUCTIONS

## AIR GAP

Model No: **6-027 & 6-291**

# NEWPORT BRASS

Flawless Beauty. From Faucet to Finish.™

### Recommended Installation by a Professional Plumbing Contractor

Note: The use of petroleum base plumbers putty on our products will nullify the warranty. We recommend the use of clear silicone sealing materials. Recommended deck thru hole  $\varnothing$  1.25" to  $\varnothing$  1.38"

### 1. INSTALLING FAUCET TO AIR GAP (See Fig 1)

**Note:** Air gap assembly will replace the escutcheon and utilize the o-ring provided with faucet.

- Place the faucet inlet and mounting stud through air gap assembly, o-ring and mounting surface hole.
- Slide mounting crescent over mounting stud on underside of mounting surface and secure into place with mounting nut.

### 2. ATTACHING WATER SUPPLY CONNECTION (See Fig 2)

- Slide the 1/4" OD R/O water supply tube (not included) through compression nut and compression sleeve. Place insert into end of tube. Insert the end of tube into faucet inlet and thread compression nut onto the end of inlet.
- Connect 3/8" OD black tube (supplied) to drain saddle or drain clamp (not included) in waste drain. The waste drain should be installed above the p-trap on the vertical section of the tailpiece. Keep this tube on a down hill slope from the faucet, tighten firmly so tube will not pull out of drain clamp. Cut off excess tube if necessary.

**Note:** This is a gravity fed line, if there is any bend or dip in the tube, the rinse water will not flow into the drain properly. Water will back up and come out the air gap hole in the back of the faucet base.

- Connect 1/4" OD black tube (supplied) to Reverse Osmosis filter system drain (not supplied).

### 3. TEST INSTALLED FAUCET

- With handle in OFF position, turn on water supplies and check all connections for leaks.

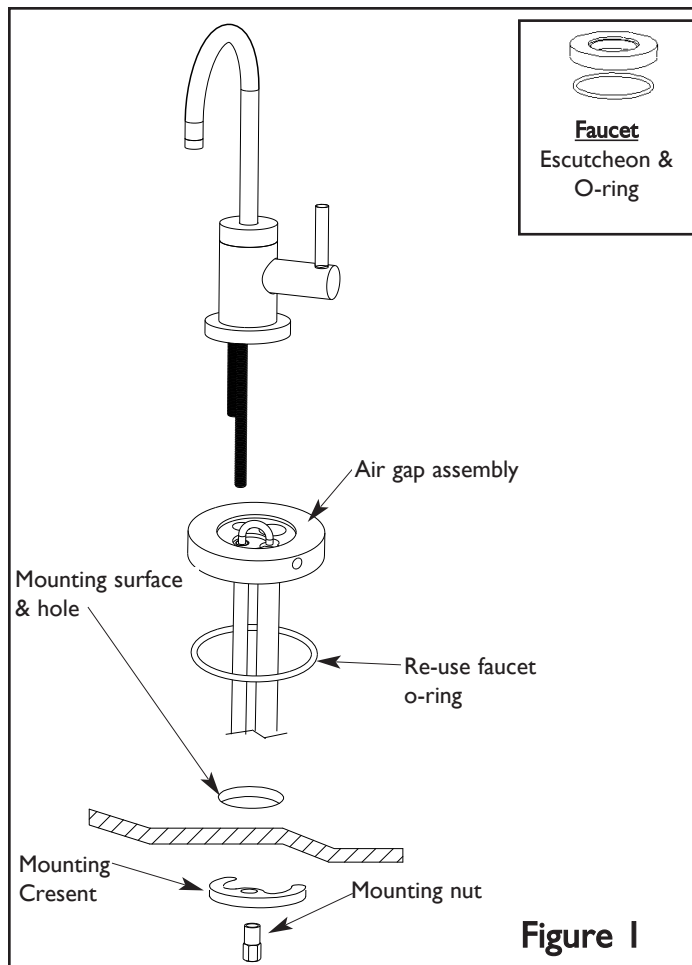

Figure 1

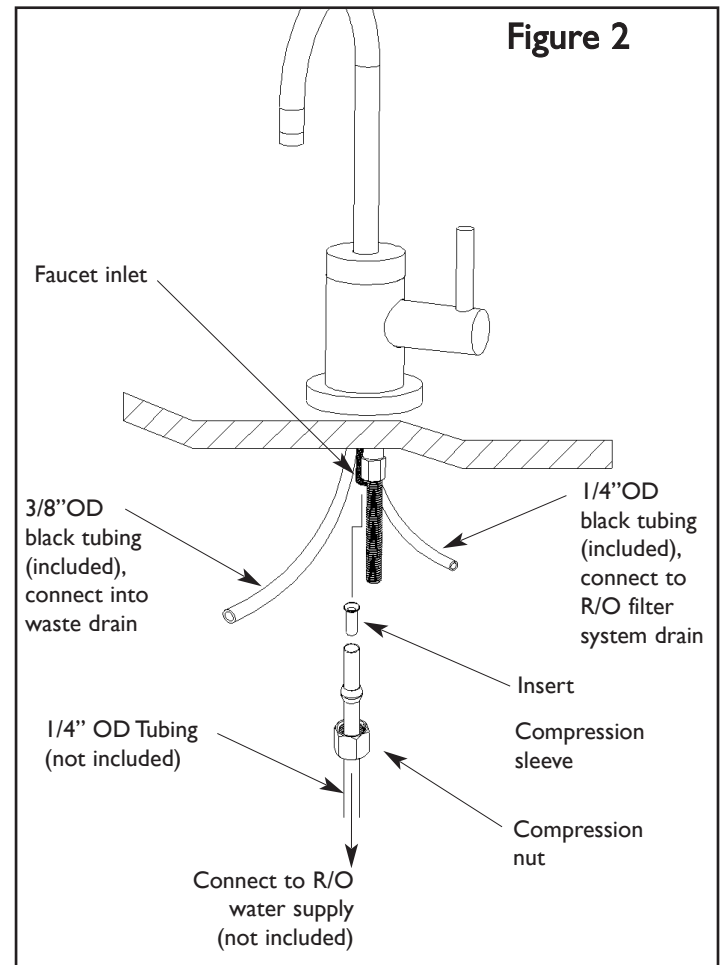

Figure 2